

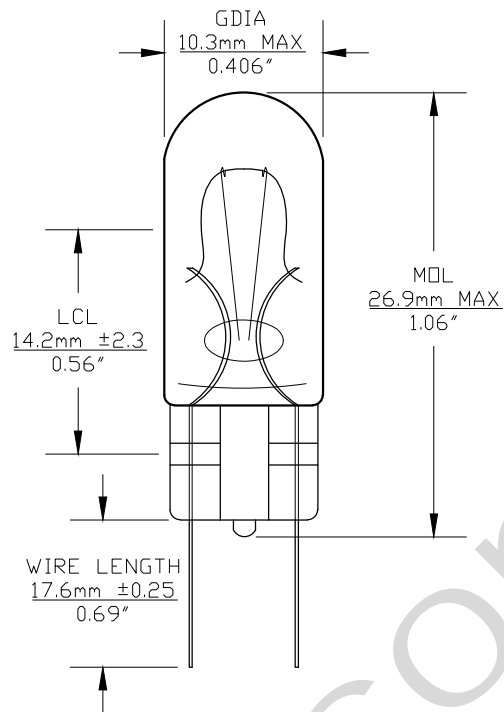

PART NO.	BASE TYPE	DESIGN VOLTS	DESIGN AMPS	MSCD	FILAMENT TYPE	AVERAGE LIFE HOURS	REVISIONS			
							REV #	DESCRIPTION	DATE	APPROVED
193E-2C	Wedge Wire Terminal	14.0V	0.33±10%	2 ±20%	C-2F	15,000	1	ISSUED	11/16/2022	M.L.

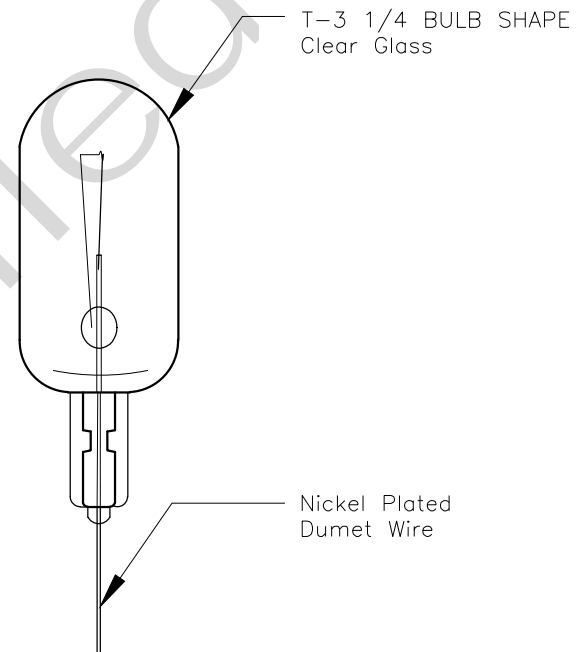

0° VIEW



90° VIEW

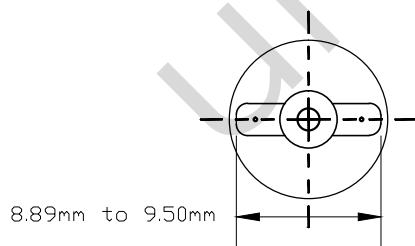

BASE BOTTOM VIEW

Note: Made according to SAE specifications



UNLESS OTHERWISE SPECIFIED: DIMENSIONS ARE IN INCHES TOLERANCES		CEC INDUSTRIES LTD			
DECIMALS	ANGULAR	599 BOND STREET LINCOLNSHIRE, IL 60069			
.XX ± .05	± 0.5°				
.XXX ± .010					
FRACTIONAL	± 1/64				
DRAWN ROSE MEDINA	DATE 11/16/2022	TITLE LIGHT BULB NO. 193E-2C			
CHECKED		SIZE A	FSCM NO.	DWG NO. 193E-2C	REV 1
DESIGN		SCALE	PLOT SCALE	SHEET 1 OF 1	
MATERIAL		FILE 193E-2C.pdf	DRAWING NOT TO SCALE		